

Slip On Flanges - ANSI B16.5

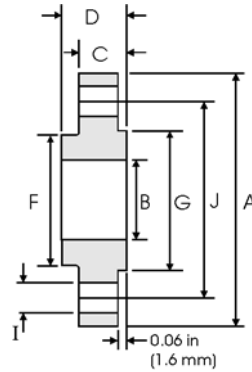

Class 300 lb

| Nominal Pipe Size | Pipe | Flange Data | | | | Hub | Raised Face | Drilling Data | | | Weight |
|-------------------|------------------|------------------|-----------------|----------------------|----------------|----------------|----------------|-----------------|--------------------|-----------------------------|-----------|
| | | A | B | C | D | F | G | H | I | J | |
| | Outside Diameter | Overall Diameter | Inside Diameter | Flange Thickness min | Overall Length | Hub Diameter | Face Diameter | Number of Holes | Bolt Hole Diameter | Diameter of Circle of Holes | kg/ piece |
| in mm | in mm | in mm | in mm | in mm | in mm | in mm | | in mm | in mm | | |
| 1/2 | 0.840 21.30 | 3.750 95.20 | 0.880 22.40 | 0.560 14.20 | 0.880 22.40 | 1.500 38.10 | 1.380 35.10 | 4 | 0.620 15.70 | 2.620 66.55 | 0.64 |
| 3/4 | 1.050 26.70 | 4.620 117.3 | 1.090 27.70 | 0.620 15.70 | 1.000 25.40 | 1.880 47.70 | 1.690 42.90 | 4 | 0.750 19.10 | 3.250 82.50 | 1.12 |
| 1 | 1.315 33.40 | 4.880 123.9 | 1.360 34.50 | 0.690 17.50 | 1.060 26.90 | 2.120 53.80 | 2.000 50.80 | 4 | 0.750 19.10 | 3.500 88.90 | 1.36 |
| 1 1/4 | 1.660 42.20 | 5.250 133.3 | 1.700 43.20 | 0.750 19.00 | 1.060 26.90 | 2.500 63.50 | 2.500 63.50 | 4 | 0.750 19.10 | 3.880 98.60 | 1.68 |
| 1 1/2 | 1.900 48.30 | 6.120 155.4 | 1.950 49.50 | 0.810 20.60 | 1.190 30.20 | 2.750 69.85 | 2.880 73.15 | 4 | 0.880 22.40 | 4.500 114.3 | 2.49 |
| 2 | 2.375 60.30 | 6.500 165.1 | 2.440 62.00 | 0.880 22.30 | 1.310 33.20 | 3.310 84.00 | 3.620 91.90 | 8 | 0.750 19.10 | 5.000 127.0 | 2.87 |
| 2 1/2 | 2.875 73.00 | 7.500 190.5 | 2.940 74.70 | 1.000 25.40 | 1.500 38.10 | 3.940 100.0 | 4.120 104.6 | 8 | 0.880 22.40 | 5.880 149.4 | 4.32 |
| 3 | 3.500 88.90 | 8.250 209.5 | 3.570 90.70 | 1.120 28.40 | 1.690 42.90 | 4.620 117.3 | 5.000 127.0 | 8 | 0.880 22.40 | 6.620 168.1 | 5.85 |
| 3 1/2 | 4.000 101.6 | 9.000 228.6 | 4.070 103.4 | 1.190 30.20 | 1.750 44.40 | 5.250 133.3 | 5.500 139.7 | 8 | 0.880 22.40 | 7.250 184.2 | 7.34 |
| 4 | 4.500 114.3 | 10.00 254.0 | 4.570 116.1 | 1.250 31.70 | 1.880 47.70 | 5.750 146.0 | 6.190 157.2 | 8 | 0.880 22.40 | 7.880 200.1 | 9.61 |
| 5 | 5.563 141.3 | 11.00 279.4 | 5.660 143.8 | 1.380 35.00 | 2.000 50.80 | 7.000 177.8 | 7.310 185.7 | 8 | 0.880 22.40 | 9.250 234.9 | 12.3 |
| 6 | 6.625 168.3 | 12.50 317.5 | 6.720 170.7 | 1.440 36.50 | 2.060 52.30 | 8.120 206.2 | 8.500 215.9 | 12 | 0.880 22.40 | 10.62 269.7 | 15.6 |
| 8 | 8.625 219.1 | 15.00 381.0 | 8.720 221.5 | 1.620 41.10 | 2.440 61.90 | 10.25 260.3 | 10.62 269.7 | 12 | 1.000 25.40 | 13.00 330.2 | 24.2 |
| 10 | 10.75 273.0 | 17.50 444.5 | 10.88 276.3 | 1.880 47.70 | 2.620 66.55 | 12.62 320.5 | 12.75 323.9 | 16 | 1.120 28.40 | 15.25 387.3 | 34.1 |
| 12 | 12.75 323.8 | 20.50 520.7 | 12.88 327.1 | 2.000 50.80 | 2.880 73.15 | 14.75 374.6 | 15.00 381.0 | 16 | 1.250 31.70 | 17.75 450.8 | 49.8 |
| 14 | 14.00 355.6 | 23.00 584.2 | 14.14 359.1 | 2.120 53.80 | 3.000 76.20 | 16.75 425.4 | 16.25 412.8 | 20 | 1.250 31.70 | 20.25 514.4 | 69.9 |
| 16 | 16.00 406.4 | 25.50 647.7 | 16.16 410.5 | 2.250 57.15 | 3.250 82.50 | 19.00 482.6 | 18.50 469.9 | 20 | 1.380 35.00 | 22.50 571.5 | 88.1 |
| 18 | 18.00 457.2 | 28.00 711.2 | 18.18 461.8 | 2.380 60.45 | 3.500 88.90 | 21.00 533.4 | 21.00 533.4 | 24 | 1.380 35.00 | 24.75 628.7 | 109 |
| 20 | 20.00 508.0 | 30.50 774.7 | 20.20 513.1 | 2.500 63.50 | 3.750 95.20 | 23.12 587.2 | 23.00 584.2 | 24 | 1.380 35.00 | 27.00 685.8 | 134 |
| 24 | 24.00 609.6 | 36.00 914.4 | 24.25 616.0 | 2.750 69.85 | 4.190 106.4 | 27.62 701.5 | 27.25 692.2 | 24 | 1.620 41.00 | 32.00 812.8 | 201 |

Notes

- Weights are based on manufacturer's data and are approximate.
- Flat face flanges may be provided at full thickness, C, or with raised face removed (the latter is nonstandard).
- For ring joint facings see page 8-6.
- For tolerances see page 8-4.